



BUILDING CODE COMPLIANCE OFFICE (BCCO)  
PRODUCT CONTROL DIVISION

MIAMI-DADE COUNTY, FLORIDA  
METRO-DADE FLAGLER BUILDING  
140 WEST FLAGLER STREET, SUITE 1603  
MIAMI, FLORIDA 33130-1563  
(305) 375-2901 FAX (305) 375-2908

**NOTICE OF ACCEPTANCE (NOA)**

[www.miamidade.gov/buildingcode](http://www.miamidade.gov/buildingcode)

**Nan Ya Plastics Corporation USA**  
8909 North Loop East, Suite 800  
Houston, TX 77029

**SCOPE:**

This NOA is being issued under the applicable rules and regulations governing the use of construction materials. The documentation submitted has been reviewed by Miami-Dade County Product Control Division and accepted by the Board of Rules and Appeals (BORA) to be used in Miami Dade County and other areas where allowed by the Authority Having Jurisdiction (AHJ).

This NOA shall not be valid after the expiration date stated below. The Miami-Dade County Product Control Division (In Miami Dade County) and/or the AHJ (in areas other than Miami Dade County) reserve the right to have this product or material tested for quality assurance purposes. If this product or material fails to perform in the accepted manner, the manufacturer will incur the expense of such testing and the AHJ may immediately revoke, modify, or suspend the use of such product or material within their jurisdiction. BORA reserves the right to revoke this acceptance, if it is determined by Miami-Dade County Product Control Division that this product or material fails to meet the requirements of the applicable building code.

This product is approved as described herein, and has been designed to comply with the Florida Building Code, including the High Velocity Hurricane Zone.

**DESCRIPTION: Series "Gliding" Fiberglass Sliding Glass Door (OXXO) – L.M.I.**

**APPROVAL DOCUMENT:** Drawing No. NAYT0009, titled "Fiberglass Gliding French Patio Door w/ sidelites", sheets 1 through 7 of 7, dated 07/28/08 and lat revised on 08-12-08, prepared by PTC Engineering, Inc., signed and sealed by Douglas J. McDougall, P.E., bearing the Miami-Dade County Product Control Approval stamp with the Notice of Acceptance number and approval date by the Miami-Dade County Product Control Division.

**MISSILE IMPACT RATING: Large and Small Missile Impact Resistant**

**LABELING:** Each unit shall bear a permanent label with the manufacturer's name or logo, city, state and following statement: "Miami-Dade County Product Control Approved", unless otherwise noted herein.

**RENEWAL** of this NOA shall be considered after a renewal application has been filed and there has been no change in the applicable building code negatively affecting the performance of this product.

**TERMINATION** of this NOA will occur after the expiration date or if there has been a revision or change in the materials, use, and/or manufacture of the product or process. Misuse of this NOA as an endorsement of any product, for sales, advertising or any other purposes shall automatically terminate this NOA. Failure to comply with any section of this NOA shall be cause for termination and removal of NOA.

**ADVERTISEMENT:** The NOA number preceded by the words Miami-Dade County, Florida, and followed by the expiration date may be displayed in advertising literature. If any portion of the NOA is displayed, then it shall be done in its entirety.

**INSPECTION:** A copy of this entire NOA shall be provided to the user by the manufacturer or its distributors and shall be available for inspection at the job site at the request of the Building Official.

This NOA consists of this page 1 and evidence page E-1, as well as approval document mentioned above. The submitted documentation was reviewed by **Ishaq I. Chanda, P.E.**



NOA No 08-0416.04  
Expiration Date: September 18, 2013  
Approval Date: September 18, 2008  
Page 1

Handwritten initials and date: 6/28/08

**Nan Ya Plastics Corporation USA**

**NOTICE OF ACCEPTANCE: EVIDENCE SUBMITTED**

**A. DRAWINGS**

1. Manufacturer's die drawings and sections.
2. Drawing No. **NAYT0009**, titled "Fiberglass Gliding French Patio Door w/sidelites", sheets 1 through 7 of 7, dated 07/28/08 and last revised on 08-12-08, prepared by PTC Engineering, Inc., signed and sealed by Douglas J. McDougall, P.E.

**B. TESTS**

1. Test reports on 1) Air Infiltration Test, per FBC, TAS 202-94  
2) Uniform Static Air Pressure Test, Loading per FBC TAS 202-94  
3) Water Resistance Test, per FBC, TAS 202-94  
4) Large Missile Impact Test per FBC, TAS 201-94  
5) Cyclic Wind Pressure Loading per FBC, TAS 203-94  
6) Forced Entry Test, per FBC 3603.2 (b) and TAS 202-94  
along with marked-up drawings and installation diagram of Fiberglass Sliding glass door (OXXO), prepared by Certified Testing Lab, Test Report No. **CTLA 1602 WR**, dated 07/25/05, signed and sealed by Ramesh Patel, P.E.  
Note: This test report has been revised on 03/09/07 issued by CTLA, signed & sealed by Ramesh Patel, P.E.

**C. CALCULATIONS**

1. Anchor verification calculations and structural analysis, complying with FBC-2004, prepared by PTC Engineering, Inc., dated 8/24/05, signed and sealed by Marlon S. Hampton, P.E.
2. Glazing Complies with ASTM E1300-02

**D. QUALITY ASSURANCE**

1. Miami Dade Building Code Compliance Office (BCCO).

**E. MATERIAL CERTIFICATIONS**

1. Notice of Acceptance No. 03-0827.08 issued to Solutia Inc. for their "Solutia Interlayers" dated 03/04/04, expiring on 03/04/09.
2. Test report No.ETC-05-255-17144.0, prepared by ETC Laboratories, dated 07/03/08, issued to Nan Ya Plastics Corp., for their Rigid PVC plastic( part #ETC06024) per ASTM D1929-96 "*Standard Test Method for Ignition Properties of Plastics*", ASTM D2843-99 "*Standard Test Method for Density of Smoke from the Burning or Decomposition of Plastics*", ASTM D635-98 "*Standard Test Method for Rate of Burning and/or Extent and Time of Burning of Self-Supporting Plastics in a Horizontal Position*" and ASTM D638-03 "*Standard Test Methods for Tensile Properties of Plastics*" for exposed & unexposed sample per Xenon Arch after 4500 Hours, signed and sealed by Joseph Labora Doldan, P.E.
3. Test report No.ETC-06-255-17412.0, prepared by ETC Laboratories, dated 04/25/06, issued to Nan Ya Plastics Corp., for their Phenolic Foam Board / ETC06013 plastic per ASTM E-E84-05 "*Standard Test Method for Surface Burning Characteristics of Building Materials*", signed and sealed by Joseph Labora Doldan, P.E.

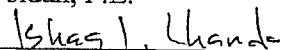

Ishaq I. Chanda, P.E.

Product Control Examiner

NOA No 08-0416.04

Expiration Date: September 18, 2013

Approval Date: September 18, 2008

**Nan Ya Plastics Corporation USA**

**NOTICE OF ACCEPTANCE: EVIDENCE SUBMITTED**

**F. MATERIAL CERTIFICATIONS (continue)**

3. Test report No.ETC-05-255-17412.1, prepared by ETC Laboratories, dated 04/25/06, re-issued on 06/28/06 to Nan Ya Plastics Corp., for their Phenolic Foam Board / ETC06013 plastic per ASTM-E84-05 "*Standard Test Method for Surface Burning Characteristics of Building Materials*", signed and sealed by Joseph L. Doldan, P.E.
4. Test report No.ETC-05-255-17900.0, prepared by ETC Laboratories, dated 06/28/06, issued to Nan Ya Plastics Corp., for their Phenolic Foam Board / ETC06013 plastic per ASTM D1929-96 "*Standard Test Method for Ignition Properties of Plastics*", signed and sealed by Joseph L. Doldan, P.E.
5. Test report No.ETC-05-255-16776.0, prepared by ETC Laboratories, dated 01/04/06, issued to Nan Ya Plastics Corp., for their SMC / ETC05033 plastic per ASTM D1929-96 "*Standard Test Method for Ignition Properties of Plastics*", ASTM D2843-99 "*Standard Test Method for Density of Smoke from the Burning or Decomposition of Plastics*", ASTM D635-98 "*Standard Test Method for Rate of Burning and/or Extent and Time of Burning of Self-Supporting Plastics in a Horizontal Position*" and ASTM D638-03 "*Standard Test Methods for Tensile Properties of Plastics*", signed and sealed by Joseph Labora Doldan, P.E.
6. Test report No.ETC-05-255-16776.1, prepared by ETC Laboratories, dated 07/06/06, issued to Nan Ya Plastics Corp., for their SMC Fiberglass Material / ETC05033 plastic per ASTM D1929-96 "*Standard Test Method for Ignition Properties of Plastics*", ASTM D2843-99 "*Standard Test Method for Density of Smoke from the Burning or Decomposition of Plastics*", ASTM D635-98 "*Standard Test Method for Rate of Burning and/or Extent and Time of Burning of Self-Supporting Plastics in a Horizontal Position*" and ASTM D638-03 "*Standard Test Methods for Tensile Properties of Plastics*", signed and sealed by Joseph Labora Doldan, P.E.
7. Test report No.ETC-05-255-16777.1, prepared by ETC Laboratories, dated 07/26/06, issued to Nan Ya Plastics Corp., for their Cellular PVC / ETC05034 plastic per ASTM D1929-96 "*Standard Test Method for Ignition Properties of Plastics*", ASTM D2843-99 "*Standard Test Method for Density of Smoke from the Burning or Decomposition of Plastics*", ASTM D635-98 "*Standard Test Method for Rate of Burning and/or Extent and Time of Burning of Self-Supporting Plastics in a Horizontal Position*" and ASTM D638-03 "*Standard Test Methods for Tensile Properties of Plastics*", signed and sealed by Joseph Labora Doldan, P.E.

**G. STATEMENTS**

1. Statement letter of conformance and no financial interest, issued by PTC, dated Feb 29, 2008, signed and sealed by Douglas J. McDougall, P.E.
2. Lab compliance letter as part of test report.

**H. OTHER**

1. None.

Ishaq I. Chanda

Ishaq I. Chanda, P.E.  
Product Control Examiner  
NOA No 08-0416.04  
Expiration Date: August 3, 2011  
Approval Date: August 3, 2006

**GENERAL NOTES:**

- THE PRODUCT ANCHORAGE SHOWN HEREIN IS DESIGNED TO COMPLY WITH THE 2004 FLORIDA BUILDING CODE (FBC) AND ITS 2005, 2006, AND 2007 SUPPLEMENTS, INCLUDING HIGH VELOCITY HURRICANE ZONE (HVHZ) REQUIREMENTS, AND AT THE DESIGN PRESSURES STATED HEREIN.
- THE PRODUCT DETAILS CONTAINED HEREIN ARE BASED UPON SIGNED AND SEALED TEST REPORT CITA 1602WR AND ASSOCIATED LABORATORY STAMPED DRAWINGS. THE PRODUCT HAS BEEN EVALUATED FOR CONFORMANCE TO THE STANDARDS LISTED IN THE 2004 FLORIDA BUILDING CODE, AND IS IN COMPLIANCE WITH SAID STANDARDS, INCLUDING HVHZ REQUIREMENTS.
- ADEQUACY OF THE EXISTING STRUCTURAL CONCRETE/MASONRY AND WOOD FRAMING AS A MAIN WIND FORCE RESISTING SYSTEM CAPABLE OF WITHSTANDING AND TRANSFERRING APPLIED PRODUCT LOADS TO THE FOUNDATION IS THE RESPONSIBILITY OF THE ENGINEER OR ARCHITECT OF RECORD FOR THE PROJECT OF INSTALLATION.
- 1X AND 2X BUCKS (WHEN USED) SHALL BE DESIGNED AND ANCHORED TO PROPERLY TRANSFER ALL LOADS TO THE STRUCTURE. BUCK DESIGN AND INSTALLATION IS THE RESPONSIBILITY OF THE ENGINEER OR ARCHITECT OF RECORD FOR THE PROJECT OF INSTALLATION.
- THE INSTALLATION DETAILS DESCRIBED HEREIN ARE GENERIC AND MAY NOT REFLECT ACTUAL CONDITIONS FOR A SPECIFIC SITE. IF SITE CONDITIONS CAUSE INSTALLATION TO DEVIATE FROM THE REQUIREMENTS DETAILED HEREIN, THEN THE BUILDING OFFICIAL MAY ELECT ONE OF THE FOLLOWING OPTIONS:
  - OUTSIDE HVHZ: REQUIRE THAT A LICENSED ENGINEER OR ARCHITECT PREPARE AND SUBMIT SITE SPECIFIC DOCUMENTS FOR USE WITH THIS DOCUMENT AND TO BE REVIEWED AND APPROVED BY AHJ.
  - INSIDE HVHZ: REQUIRE THAT A ONE-TIME SITE SPECIFIC APPROVAL BE APPLIED FOR AND OBTAINED FROM THE BUILDING CODE AUTHORITY HAVING JURISDICTION.
- IN AREAS WHERE WINDBORNE DEBRIS PROTECTION REQUIREMENTS EXIST, USE OF AN IMPACT PROTECTIVE SYSTEM IS NOT REQUIRED FOR THE PRODUCT HEREIN.
- DOOR FRAME AND PANEL MATERIAL:
  - COMPOSITE - FIBERGLASS/PC/WOOD/FOAM.
- GLASS MEETS THE REQUIREMENTS OF ASTM E1300-02 GLASS CHARTS. SEE SHEET 4 FOR GLAZING DETAIL.
- DESIGNATIONS "X" AND "O" STAND FOR THE FOLLOWING:
  - X: OPERABLE PANEL
  - O: FIXED PANEL
- A 1/3 INCREASE IN ALLOWABLE STRESS FOR WIND LOADS WAS NOT USED IN THE DESIGN OF THE PRODUCT SHOWN HEREIN.

# NAN YA PLASTICS CORPORATION, USA

## FIBERGLASS GLIDING FRENCH

### PATIO DOORS W/ SIDELITES OXO

**INSTALLATION NOTES:**

- ONE (1) INSTALLATION ANCHOR IS REQUIRED AT EACH ANCHOR LOCATION SHOWN.
- THE NUMBER OF INSTALLATION ANCHORS DEPICTED IS THE MINIMUM NUMBER OF ANCHORS TO BE USED FOR PRODUCT INSTALLATION.
- SHIM AS REQUIRED AT EACH INSTALLATION ANCHOR WITH LOAD BEARING SHIM(S). MAXIMUM ALLOWABLE SHIM SIZE OF 1/4 INCH. SHIM WHERE SPACE OF 1/16 INCH OR GREATER OCCURS. SHIM(S) SHALL BE CONSTRUCTED OF HIGH DENSITY LOAD BEARING PLASTIC OR BETTER.
- FOR INSTALLATION INTO WOOD FRAMING, USE #12 WOOD SCREWS OF SUFFICIENT LENGTH TO ACHIEVE 1 1/2 INCH MINIMUM EMBEDMENT.
- FOR INSTALLATION THROUGH 1X BUCK TO CONCRETE/MASONRY, OR DIRECTLY INTO CONCRETE/MASONRY, USE 1/4 INCH ELCO ULTRACONS OF SUFFICIENT LENGTH TO ACHIEVE 1 1/4 INCH MINIMUM EMBEDMENT.
- MINIMUM EMBEDMENT AND EDGE DISTANCE EXCLUDE WALL FINISHES (INCLUDING BUT NOT LIMITED TO STUCCO, FOAM, BRICK VENEER, SHEATHING AND SIDING).
- WOOD SCREWS SHALL BE MADE OF CARBON STEEL WITH BENDING YIELD STRENGTHS MEETING THE REQUIREMENTS OF AF&PA NDS-2001, APPENDIX I.
- INSTALL WOOD SCREWS IN ACCORDANCE WITH THE PROVISIONS OF THE AF&PA NDS-2001.
- INSTALL CONCRETE/MASONRY SCREWS IN ACCORDANCE WITH MANUFACTURER'S INSTALLATION INSTRUCTIONS.

- INSTALLATION ANCHORS AND ASSOCIATED HARDWARE MUST BE MADE OF CORROSION RESISTANT MATERIAL OR HAVE A CORROSION RESISTANT COATING.
- FOR HOLLOW BLOCK AND GROUT FILLED BLOCK, DO NOT INSTALL INSTALLATION ANCHORS INTO MORTAR JOINTS. EDGE DISTANCE IS MEASURED FROM FREE EDGE OF BLOCK OR EDGE OF MORTAR JOINT INTO FACE SHELL OF BLOCK.
- INSTALLATION ANCHORS SHALL NOT BE USED IN SUBSTRATES WITH STRENGTHS LESS THAN THE MINIMUM STRENGTH SPECIFIED BELOW.
- INSTALLATION ANCHOR CAPACITIES FOR PRODUCTS HEREIN ARE BASED ON SUBSTRATE MATERIALS WITH THE FOLLOWING PROPERTIES:
  - A. WOOD - MINIMUM SPECIFIC GRAVITY OF 0.50
  - B. CONCRETE - MINIMUM COMPRESSIVE STRENGTH OF 2700 PSI.
  - C. MASONRY BLOCK - MINIMUM NET COMPRESSIVE STRENGTH OF 1900 PSI.

SHEET	REVISION	SHEET DESCRIPTION
1	A	GENERAL AND INSTALLATION NOTES
2	A	ELEVATION & ANCHOR LAYOUT
3	A	VERTICAL SECTIONS
4	A	HORIZONTAL SECTIONS
5	-	COMPONENTS
6	A	COMPONENTS
7	A	BILL OF MATERIALS

LEGEND:  
 O.A.- OVERALL  
 D.L.O.- DAY LIGHT OPENING  
 O.C.- ON CENTER  
 TYP.- TYPICAL

△ - INDICATES SPECIFIC NOTE ON SAME SHEET CORRESPONDING TO THE LETTER DESIGNATION INDICATED IN FLAG.

	DESIGN PRESSURE RATING		IMPACT RATING
	WHERE WATER INFILTRATION REQUIREMENT IS NEEDED	WHERE WATER INFILTRATION REQUIREMENT IS NOT NEEDED	
POSITIVE	+50.0 PSF	+50.0 PSF	LARGE AND SMALL MISSILE IMPACT
NEGATIVE	-50.0 PSF	-50.0 PSF	

APPROVED BY: DATE: \_\_\_\_\_

NAN YA PLASTICS CORPORATION USA

8989 NORTH LOOP EAST - HOUSTON TEXAS 77029

FIBERGLASS GLIDING FRENCH PATIO DOOR W/ SIDELITES  
 GENERAL AND INSTALLATION NOTES

DATE: 07/28/08  
 DRAWING NO.: SAM  
 SCALE: N.T.S.  
 SHEET: 1 OF 7

REV: \_\_\_\_\_

FIG. LLC  
 1335 Cogswell Street, Suite C25  
 Rockledge, Florida 32955  
 P.O. Box 21,000,1700 Fax 21,000,1700

PROJECT #307-0457

Douglas J McDougall  
 Florida P.E. No. 28392  
 FIG. LLC  
 8-12-08

F.P.R.C. Certificate of Authorization No. 28935

PRODUCT REVISED  
 as complying with the Florida  
 Building Code  
 Appearance No. 06-04/16-04  
 Expiration Date: 09/16/2013

By: *Iskay J. Clark*  
 Miami District Product Control  
 Division

REV	DESCRIPTION	DATE	BY
A	AS REQUESTED PER MAM-DADE	7/10/08	CB

DATE	APPROVED BY:
07/28/08	SAM
DWG. NO.	NAN0009
SHEET:	2 of 7

PROJECT# 307-0457  
 Douglas J McDougall  
 Florida P.E. No. 28392  
 P.T.C. LLC  
 1535 Cogswell Street, Suite C25  
 Rockledge, Florida 32955  
 FBPE Certificate of Authorization No. 25935  
 Phone 321.890.1700 Fax 321.890.1708

PRODUCT REVISED  
 as complying with the Florida  
 Building Code No. 02-046.04  
 Acceptance No. 02-046.04  
 Expiration Date 02/16/2013  
 By: [Signature]  
 Project Trade Product Control  
 Division

NAN YA PLASTICS CORPORATION USA  
 8989 NORTH LOOP EAST - HOUSTON TEXAS 77029  
 FIBERGLASS GLIDING FRENCH PATIO DOOR W/ SIDELITES  
 ELEVATION & ANCHOR LAYOUT  
 PREPARED BY: P.T.C. LLC

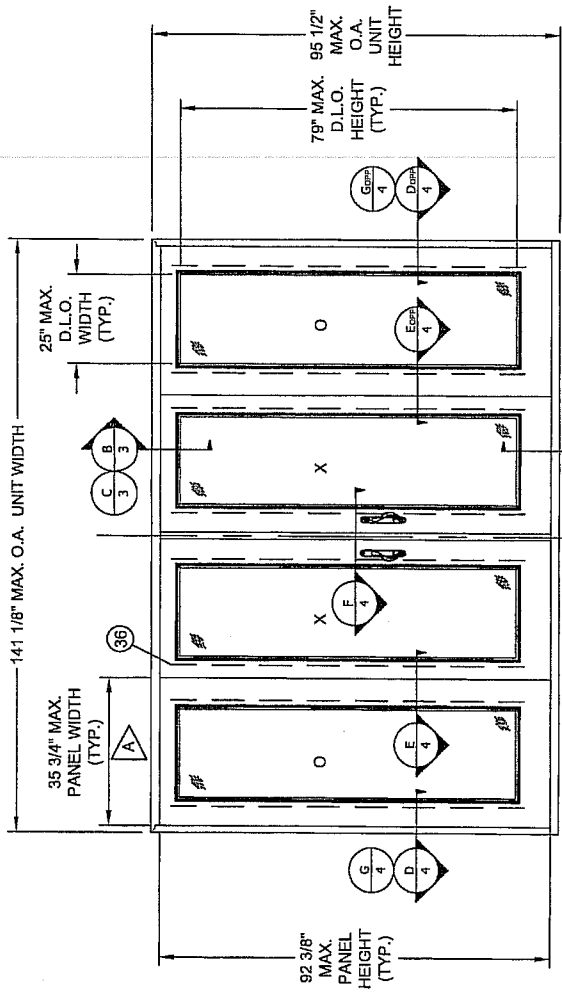

DOOR FRAME  
**ELEVATION**  
 (EXTERIOR ELEVATION)

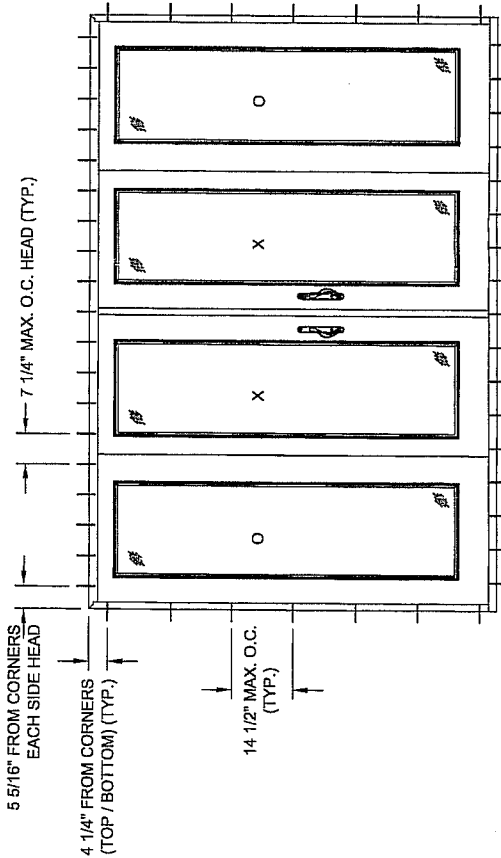

**ANCHOR LAYOUT**  
 (EXTERIOR ELEVATION)

**SPECIFIC NOTE:**  
 IF PANEL REINFORCEMENTS ARE  
 CONSIDERED IN PANEL WIDTH, THE  
 OPERABLE PANELS HAVE THE FOLLOWING  
 WIDTHS: PANEL WITH ASTRAGAL AND  
 PANEL REINFORCEMENT - 37.5". PANEL  
 WITH PANEL REINFORCEMENT ONLY - 36.5"

6 9/16" FROM CORNERS EACH SIDE SILL  
 8" MAX. O.C. SILL (TYP.)  
 14 1/2" MAX. O.C. (TYP.)  
 4 1/4" FROM CORNERS (TOP / BOTTOM) (TYP.)  
 5 5/16" FROM CORNERS EACH SIDE HEAD  
 7 1/4" MAX. O.C. HEAD (TYP.)  
 92 3/8" MAX. PANEL HEIGHT (TYP.)  
 35 3/4" MAX. PANEL WIDTH (TYP.)  
 141 1/8" MAX. O.A. UNIT WIDTH  
 25" MAX. D.L.O. WIDTH (TYP.)  
 79" MAX. D.L.O. HEIGHT (TYP.)  
 95 1/2" MAX. O.A. UNIT HEIGHT  
 INSTALLATION ANCHOR LOCATION (1 ANCHOR PER LOCATION - INTERIOR FRAME TRACK ONLY) (TYP.)

REV	DESCRIPTION	DATE	BY
A	AS REQUESTED PER MIAM-DADE	7/10/08	CB

TITLE: FIBERGLASS GLIDING FRENCH PATIO DOOR W/ SIDELITES  
 VERTICAL SECTIONS  
 8989 NORTH LOOP EAST - HOUSTON TEXAS 77029  
 NAN YA PLASTICS CORPORATION USA  
 APPROVED BY: DATE:

DWG. NO. NAN0009  
 DATE: 07/28/08  
 SAM  
 N.T.S.  
 SHEET: 3 OF 7

PREPARED BY: P.P.C. P.T.C. LLC  
 SCALE: P.P.C. P.T.C. LLC  
 Phone 281.690.1788 Fax 281.690.1789

PROJECT# 307-0457  
 Douglas J McDougall  
 Florida P.E. No. 28392  
 P.T.C. LLC  
 1535 Cogswell Street, Suite C25  
 Rockledge, Florida 32955  
 FPE Certificate of Authorization NO. 28935

PRODUCT REVISED  
 as supplying with the Florida  
 Building Code  
 Acceptance No. 03-016-01  
 Expiration Date 5/28/18/2018  
 By: [Signature]  
 Miami Trade Product Control  
 Division

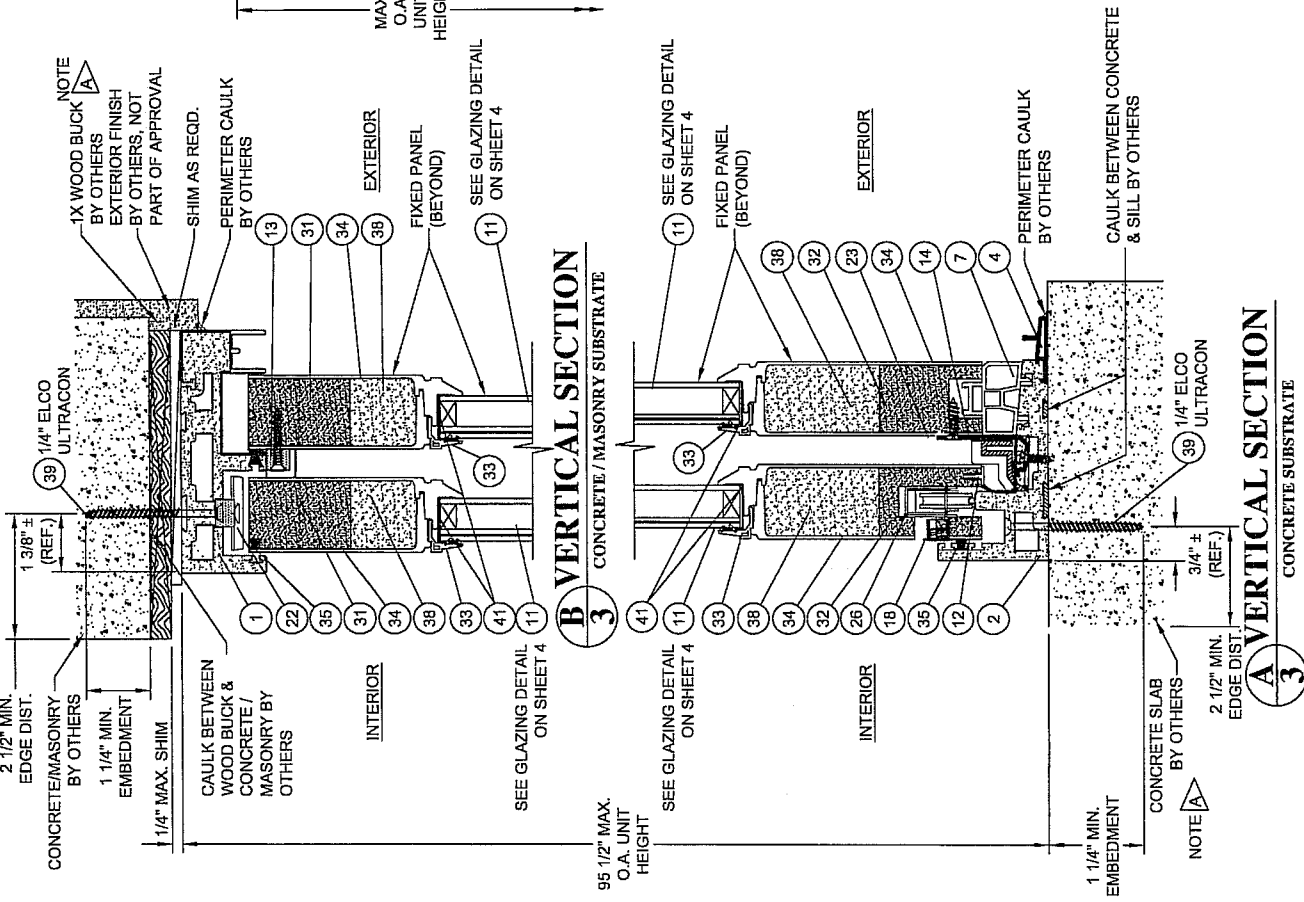
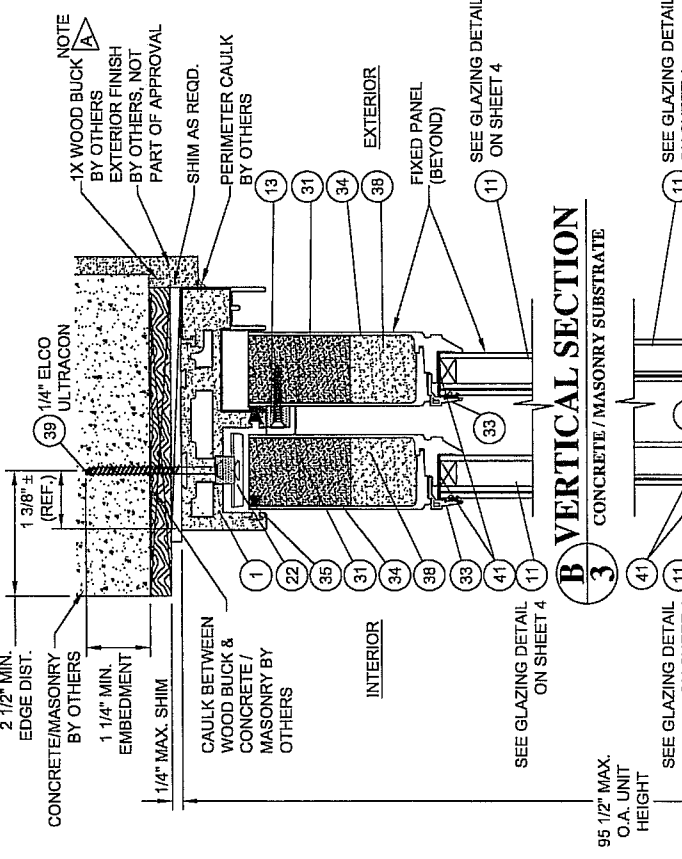
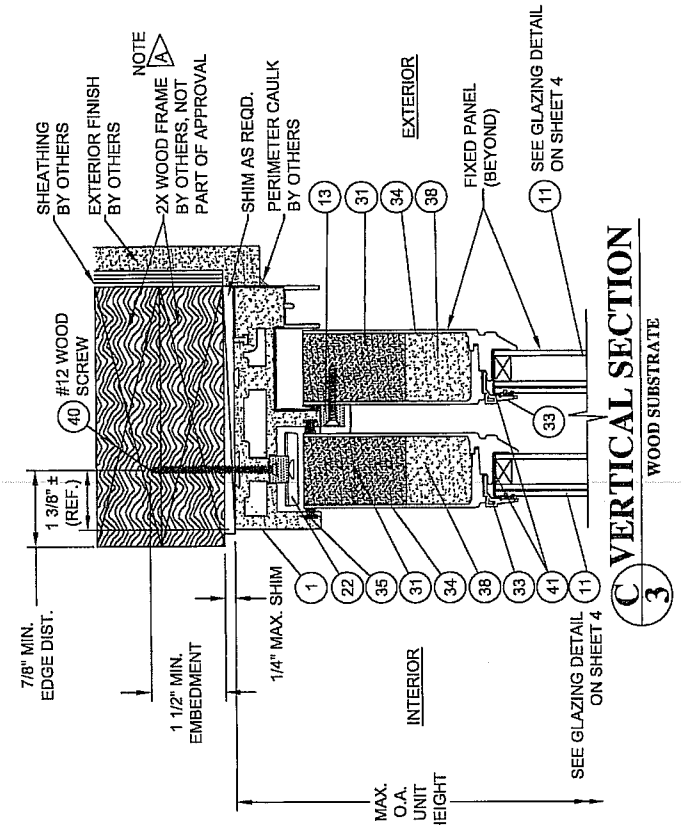

**SPECIFIC NOTE:**  
 WOOD FRAME, 1X WOOD BUCK AND CONCRETE SLAB  
 MUST PROVIDE FULL SUPPORT FOR DOOR FRAME.

DATE:	APPROVED BY:
AS REQUESTED PER M.I.M.-DATE	DESCRIPTION
7/10/08	
DATE BY	REV
	A

PROJECT# 307-0457  
 Douglas J. McDougall  
 Florida P.E. No. 28392  
 1535 Cogswell Street, Suite C25  
 Rockledge, Florida 32955  
 FPE Certificate of Authorization No. 25935

PREPARED BY: P.T.C. LLC  
 SCALE: N.T.S.  
 DATE: 07/28/08  
 DWG. NO.: NAN0009  
 SHEET: 4 OF 7

TITLE: FIBERGLASS GLIDING FRENCH PATIO DOOR W/ SIDELITES  
 HORIZONTAL SECTIONS  
 8989 NORTH LOOP EAST - HOUSTON TEXAS 77029  
 NAN YA PLASTICS CORPORATION USA

PRODUCT REVISED  
 as complying with the Florida  
 Building Code  
 Acceptance No. 08-01601  
 Expiration Date 5/31/07  
 By: *Sheng J. Li*  
 M.I.M. Trade Product Control  
 Division

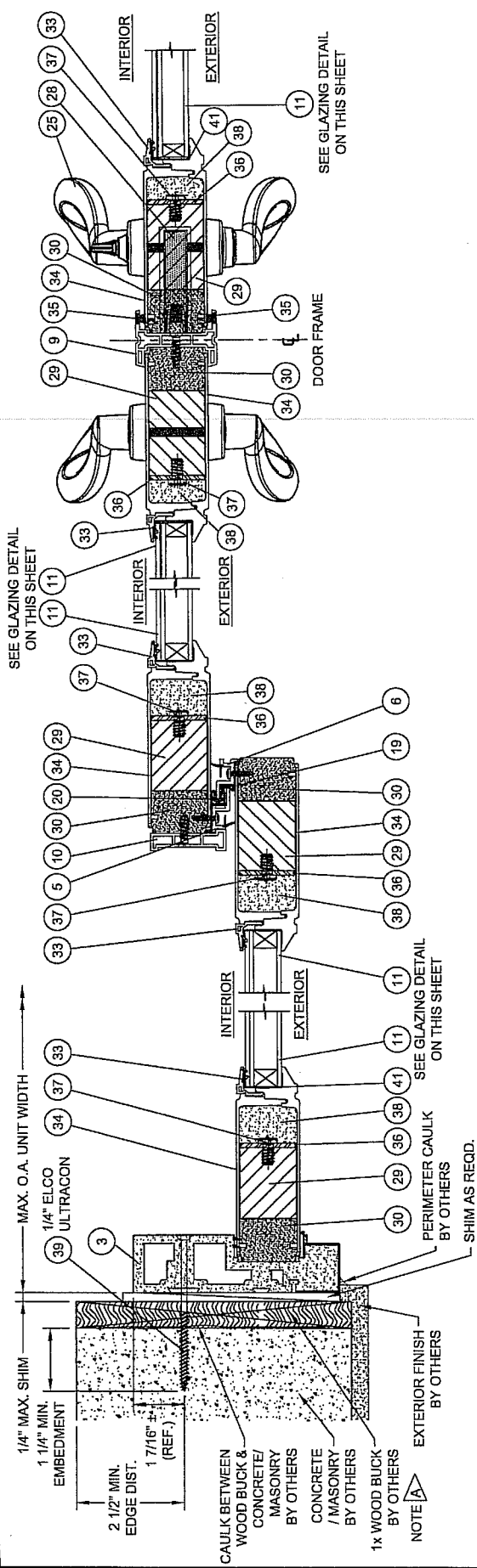

**D HORIZONTAL SECTION**  
CONCRETE / MASONRY SUBSTRATE

**E HORIZONTAL SECTION**  
INTERLOCK

**F HORIZONTAL SECTION**  
ASTRAGAL

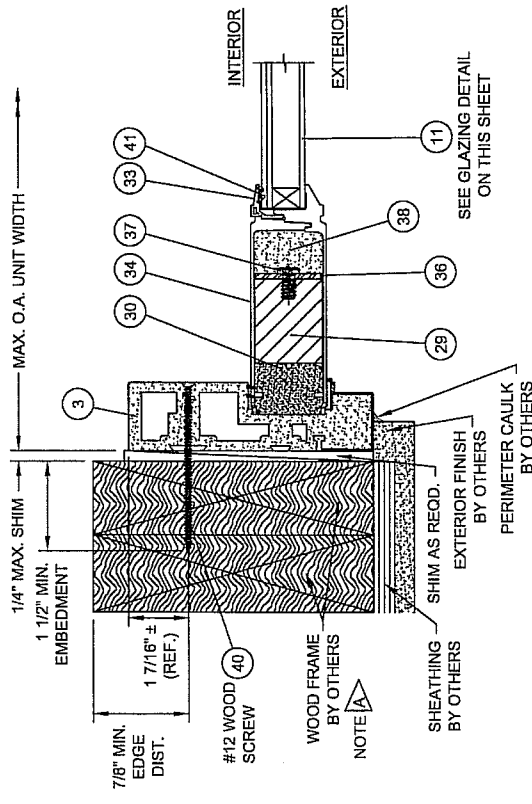

**G HORIZONTAL SECTION**  
WOOD SUBSTRATE

1" LAMINATED INSULATED UNIT BY CARDINAL GLASS  
 CONSISTING OF 1/8" TEMPERED GLASS OUTBOARD  
 LITE / ALUMINUM SPACER BAR / 1/8" ANNEALED GLASS  
 LITE / 0.090" SOLLUTIA PVB INTERLAYER / 1/8" ANNEALED  
 GLASS

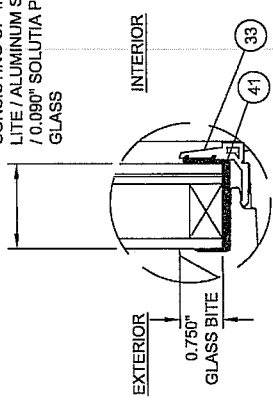

**DRY GLAZING DETAIL**

**SPECIFIC NOTE:**  
 WOOD FRAME AND 1X WOOD BUCK MUST PROVIDE  
 FULL SUPPORT FOR DOOR FRAME.

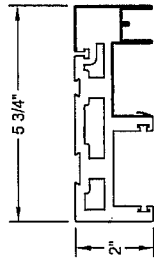

PS711

1 HEAD CELLULAR PVC

TYP. WALL THICKNESS 0.236"

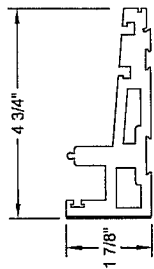

PS713

2 SILL CELLULAR PVC

TYP. WALL THICKNESS 0.236"

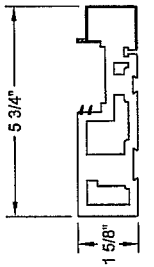

PS715

3 SIDE JAMB CELLULAR PVC

TYP. WALL THICKNESS 0.236"

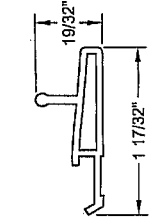

SA101

4 SCREEN TRACK ALUMINUM 6063-T5

TYP. WALL THICKNESS 0.059"

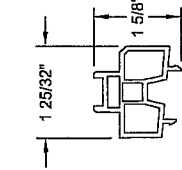

PS751

7 FIXED PANEL BASE RIGID PVC

TYP. WALL THICKNESS 0.090"

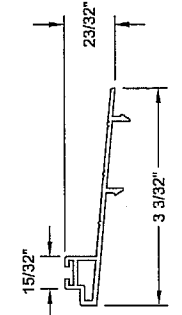

SA102

8 SILL BOARD ALUMINUM 6063-T5

TYP. WALL THICKNESS 0.059"

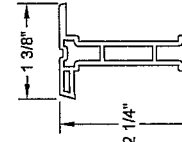

SA108

9 ASTRAGAL STRIP ALUMINUM 6063-T5

TYP. WALL THICKNESS 0.0625"

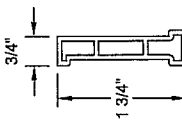

SA109

10 PANEL REINFORCEMENT ALUMINUM 6063-T5

TYP. WALL THICKNESS 0.0625"

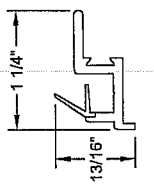

PS745

5 INTERLOCK STRIP RIGID PVC

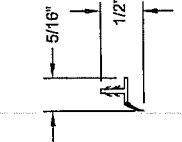

PS045

12 WEATHER STRIP PVC

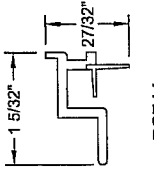

PS744

6 INTERLOCK STRIP RIGID PVC

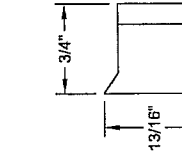

MS712

13 TOP WIND STOPPER EPDM FOAM

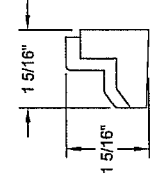

MS713

14 BOTTOM WIND STOPPER EPDM FOAM

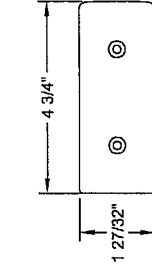

MS719

15 HEAD BUMPER PVC

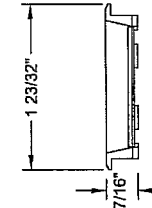

MS701

16 WEEP HOLE COVER PVC

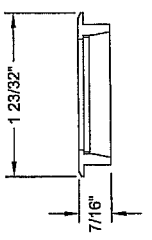

MS706

17 WEEP HOLE COVER PVC

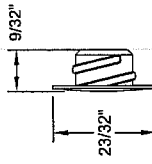

MS702

18 ROLLER ADJUST COVER PVC

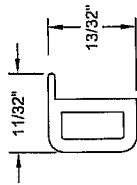

SS713

19 WEATHER STRIP EPDM FOAM

REV	DESCRIPTION	DATE	BY
A	AS REQUESTED PER MIAMI-DADE	7/10/08	CB

DATE	7/28/08
DWG. NO.	SAM
SCALE	N.T.S.
REV.	5 OF 7

PROJECT# 307-0457

Douglas J McDougall  
Florida P.E. No. 28392

PTC, LLC  
1535 Goswell Street, Suite C25  
Rockledge, Florida 32955

Phone 321.990.1788 Fax 321.990.1793

PRODUCT REVISED as complying with the Florida Building Code Acceptance Notice 06-01/6.01/ Expiration Date SEP 10 2012

By: [Signature] License No. 11444  
Miami Dade Product Control Division

APPROVED BY: DATE: 8989 NORTH LOOP EAST - HOUSTON TEXAS 77029 THE: FIBERGLASS GLIDING FRENCH PATIO DOOR W/ SIDELITES



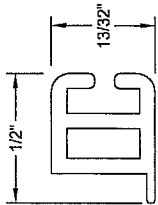

SS715

20 WEATHER STRIP  
EPDM FOAM

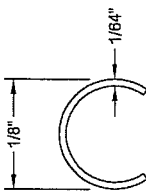

S6734

21 SILL TRACK  
STAINLESS STEEL

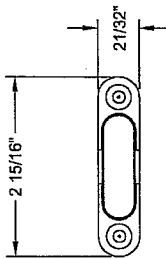

SS716

22 ANTI-LIFT BLOCK  
DIE CASTING

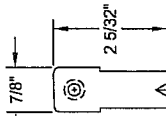

SS723

23 BOTTOM BRACKET  
STAINLESS STEEL

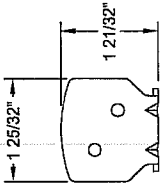

SS724

24 TOP BRACKET  
STAINLESS STEEL

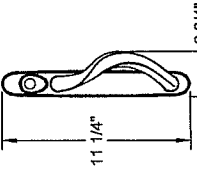

SS725

25 HANDLE SETS  
DIE CASTING

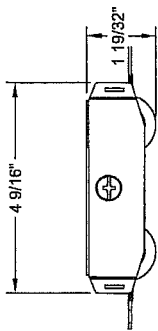

SS734

26 TANDEM ROLLER  
STAINLESS STEEL

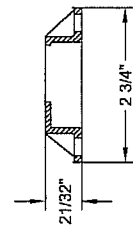

SS732

27 LOCK KEEPER  
DIE CASTING

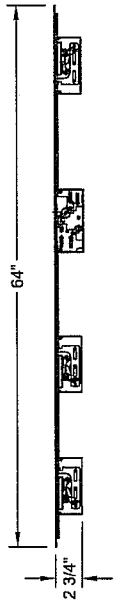

SS733

28 MULTI-POINT LOCK  
STAINLESS STEEL

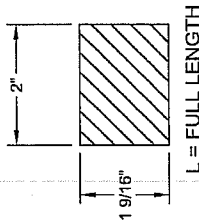

L = FULL LENGTH

29 2" REINFORCEMENT WOOD  
WHITE PINE

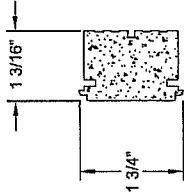

30 1 3/16" STILE  
CELLULAR PVC

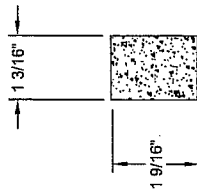

PAS74

31 TOP RAIL  
FOAM PVC

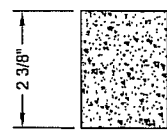

PAS7F

32 BOTTOM RAIL  
FOAM PVC

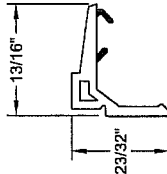

PAS04

33 GLAZING BEAD  
PVC

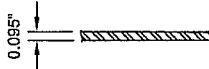

S7A62

35 WEATHER STRIP  
PVC

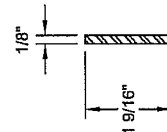

L = FULL LENGTH - 8.375

36 REINFORCEMENT  
GALVANIZED STEEL

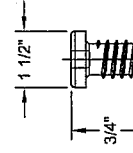

37 SCREW  
NYLON 66

APPROVED BY: DATE:

NAN YA PLASTICS CORPORATION USA

8989 NORTH LOOP EAST - HOUSTON TEXAS 77029

FIBERGLASS GUIDING FRENCH PATIO DOOR W/ SIDELITES

COMPONENTS

PREPARED BY: DATE: 07/28/08

SCALE: N.T.S.

DWG. NO. NAN0009

SHEET: 6 of 7



Phone 281.900.1788 Fax 281.900.1789

FPE Certificate of Authorization No. 25935

1536 Goswell Street, Suite C25  
Rockledge, Florida 32955

PTC, LLC  
Florida P.E. No. 28392

Douglas J McDougall

PROJECT# 307-0457

PRODUCT REVISED  
as complying with the Florida  
Building Code  
Approval No. 06-0416-04  
Expiration Date 02/15/2013  
By: [Signature]

Division  
Habitat Trade Product Control

ITEM	PART #	DESCRIPTION	MATERIALS	QTY.	VENDOR
1	PS711	HEAD	CELLUAR PVC	1	NAN YA PLASTICS
2	PS713	SILL	CELLUAR PVC	1	NAN YA PLASTICS
3	PS715	SIDE JAMB	CELLUAR PVC	2	NAN YA PLASTICS
4	SA101	SCREEN TRACK	ALUMINUM 6063-T5	1	DAWEI
5	PS745	INTERLOCK STRIP	RIGID PVC	2	NAN YA PLASTICS
6	PS744	INTERLOCK STRIP	RIGID PVC	2	NAN YA PLASTICS
7	PS751	FIXED PANEL BASE	RIGID PVC	1	NAN YA PLASTICS
8	SA102	SILL BOARD	ALUMINUM 6063-T5	1	DAWEI
9	SA108	ASTRAGAL STRIP	ALUMINUM 6063-T5	1	DAWEI
10	SA109	PANEL REINFORCEMENT	ALUMINUM 6063-T5	2	DAWEI
11	-----	1" INSULATED LAMINATED GLASS (SEE DETAIL SHEET 4)	GLASS	4	CARDINAL GLASS INC.
12	PS045	WEATHER STRIP	PVC	2	NAN YA PLASTICS
13	MS712	TOP WIND STOPPER	EPDM FOAM	2	NAN YA PLASTICS
14	MS713	BOTTOM WIND STOPPER	EPDM FOAM	2	NAN YA PLASTICS
15	MS719	HEAD BUMPER	PVC	2	NAN YA PLASTICS
16	MS701	WEEP HOLE COVER	PVC	2	NAN YA PLASTICS
17	MS706	WEEP HOLE COVER	PVC	2	NAN YA PLASTICS
18	MS702	ROLLER ADJUST COVER	PVC	2	NAN YA PLASTICS
19	SS713	WEATHER STRIP	EPDM FOAM	2	NAN YA PLASTICS
20	SS715	WEATHER STRIP	EPDM FOAM	2	NAN YA PLASTICS
21	S6734	SILL TRACK	STAINLESS STEEL	1	JIUH-CHUAN LOCK CO.
22	SS716	ANTI-LIFT BLOCK	DIE CASTING	2	JIUH-CHUAN LOCK CO.
23	SS723	BOTTOM BRACKET	STAINLESS STEEL	2	JIUH-CHUAN LOCK CO.
24	SS724	TOP BRACKET	STAINLESS STEEL	2	JIUH-CHUAN LOCK CO.
25	SS725	HANDLE SETS	DIE CASTING	2	MICOTA
26	SS734	TANDEM ROLLER	STAINLESS STEEL	4	MICOTA
27	SS732	LOCK KEEPER	DIE CASTING	3	MICOTA
28	SS733	MULTI POINT LOCK	STAINLESS STEEL	1	MICOTA
29	-----	2" REIN. WOOD	WHITE PINE	8	DENG XAV
30	-----	1 3/16" STILE	CELLUAR PVC	8	NAN YA PLASTICS
31	PAS74	TOP RAIL	FOAM PVC	4	NAN YA PLASTICS
32	PAS7F	BOTTOM RAIL	FOAM PVC	4	NAN YA PLASTICS
33	PAS04	GLAZING BEAD	PVC	16	NAN YA PLASTICS
34	-----	SMC SKIN	FIBERGLASS	8	NAN YA PLASTICS
35	S7A62	WEATHER PILE	PVC	6	TIN FU YI
36	-----	REINFORCEMENT	STEEL	8	CSC
37	-----	SCREW	NYLON 66	36	NAN YA PLASTICS
38	-----	PU FOAM / PHENOLIC FOAM	PU / PHENOLIC	36	NAN YA PLASTICS
39	-----	1/4" ELCO ULTRACON (INSTALLATION ANCHOR)	CARBON STEEL	AS REQ'D	ELCO
40	-----	#12 WOOD SCREW (INSTALLATION ANCHOR)	CARBON STEEL	AS REQ'D	-----
41	-----	DOW CORNING 995	STRUCTURAL SEALANT	AS REQ'D	-----

APPROVED BY: \_\_\_\_\_ DATE: \_\_\_\_\_

NAN YA PLASTICS CORPORATION USA  
8989 NORTH LOOP EAST - HOUSTON TEXAS 77029

FIBERGLASS GLIDING FRENCH PATIO DOOR W/ SIDELITES  
BILL OF MATERIALS

REVISED BY: \_\_\_\_\_  
SCALE: SAM DATE: 07/28/08  
DWG. NO.: NAN0009 SHEET: 7 OF 7

REV: A AS REQUESTED PER MAINT-DADE 7/10/08 CB

PROJECT# 307-0457

Douglas J McDougall  
Florida P. E. No. 28392

PTG. LLC  
1636 Cogswell Street, Suite C25  
Rockledge, Florida 32955  
FBPE Certificate of Authorization NO. 25935

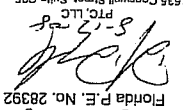

PRODUCT REVISED  
in compliance with the Florida  
Building Code  
Acceptance Notice - 04/16/04  
Expiration Date 05/18/04

By: \_\_\_\_\_  
Miami Dade Product Control  
Division